

INSTRUCTION MANUAL

- DVD/MP3/AM/FM/CD Receiver
- 4" TFT-LCD Touchscreen Display with 3.2" View Area
- Flip Down/Full Detachable Front Panel
- DVD/DVD-R/DVD-RW/SVCD/VCD/MP4/MP3/WMA/CD-R/CD-RW Compatible
- SD/MMC/USB Compatible
- Front AUX Input

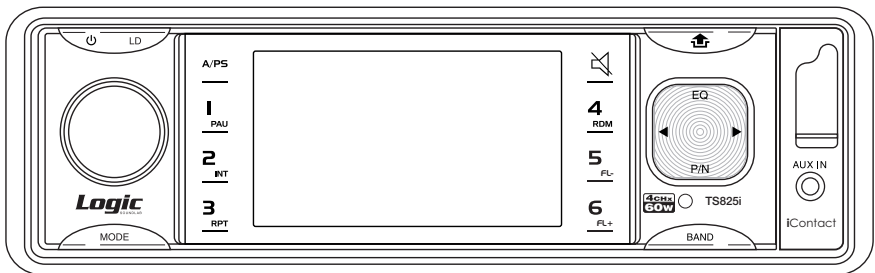

PLEASE READ THIS INSTRUCTION MANUAL CAREFULLY BEFORE OPERATING YOUR UNIT.

TS825i

MP3-Compatible AM/FM DVD Receiver

INSTRUCTION MANUAL

Introduction:

Congratulations! You have purchased the next generation in automotive multimedia receivers. Our engineers have spent years to bring you the best car stereo players available. This unit features next generation Advanced "SMART USB" technology, SD/MMC compatible memory card reader and "AUX IN" input to enhance your car audio experience.

Included with this unit you will find two iContact cables, IC-110 and IC-120. IC-110 is used for direct connection of your portable media player such as iPod* and other digital MP3 Players. IC-120 is used for next generation MP3/cellular phones.

* iPod is a registered trademark of Apple Computers, Inc.

Logic®
SOUNDLAB

CONTENTS

Before You Begin	2
Installation	3
Installation in the Dashboard	3
Detaching and Attaching the front panel	3
Supporting the Unit	4
Wiring Connection	4-5
Operation	6
Locations of Controls (Main Unit)	6
Locations of Controls (Remote Control)	7
General Operations	8
Listening to Radio	9
Operations Common for CD/MP3/WMA/VCD/DVD/MP4	10
Listening to CD/MP3/WMA	11
Playing DVD/VIDEO CD/MP4	12
Customizing Audio/Video Settings	13
Setting Up the DVD Player	14
Troubleshooting	15
Problem During DVD/VCD Playback	16
Specifications	17

BEFORE YOU BEGIN

PRECAUTIONS:

CAUTION:
USE OF CONTROLS OR ADJUSTMENT OR PERFORMANCE OF PROCEDURES OTHER THAN THOSE SPECIFIED HEREIN MAY RESULT IN HAZARDOUS RADIATION EXPOSURE.

THE USE OF OPTICAL INSTRUMENTS WITH THIS PRODUCT WILL INCREASE EYE HAZARD.

- Keep this manual handy as a reference for operating procedures and precautions.
- Always keep the volume low enough so you can hear sounds outside of the car.
- Protect this product from moisture.
- If the battery is disconnected or discharged, the preset memory will be erased and must be reprogrammed.

FEATURES:

DVD video playback

This unit plays DVD video, DVD+-R, DVD+-RW and DVD+-DL.

Video CDs featuring PBC compatibility

This unit plays Video CDs featuring PBC (Playback Control).

CD playback

This unit plays Music CD/CD-R/CD-RW.

MP3/WMA file playback

This unit plays MP3/WMA files recorded on CD-ROM/CD-R/CD-RW.

MP4 file playback

This unit plays MP4 files.

PAL/NTSC compatibility

This unit is PAL/NTSC system compatible. When connecting other components to this unit, be sure components are compatible with the same video system or else images will not be correctly reproduced.

Multi-audio

You can switch between multiple audio systems recorded on a DVD as desired.

Multi-subtitle

You can switch between multiple subtitle languages recorded on a DVD as desired.

Multi-angle

You can switch between multiple viewing angles of a scene recorded on a DVD as desired.

When an operation is prohibited

When you are watching a DVD and attempt to perform an operation that is not permitted by the programming on the disc a message appears on the screen.

INSTALLATION

PRECAUTIONS

- Choose the mounting location carefully so that the unit will not interfere with normal driving functions.
- Avoid installing the unit where it would be subject to high temperatures, such as from direct sunlight or hot air from the heater, or where it would be subject to dust, dirt or excessive vibration.
- Use only the supplied mounting hardware for a safe and secure installation.
- Be sure to remove the front panel before installing the unit.

NOTE: Inclination angle for car radio installation must not exceed 30° otherwise the front panel will not open.

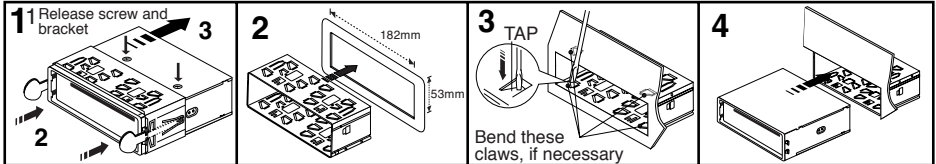

NOTE: Keep the release key in a safe place as you may need it in future to remove the unit from the car.

Detaching and attaching the front panel

The front panel of this unit can be detached to prevent theft.

FOLDING DOWN AND DETACHING/ATTACHING THE FRONT PANEL

Before detaching the front panel, be sure to press the button (1) OFF first.

Then press the button and detach the panel by pulling it towards you as illustrated.

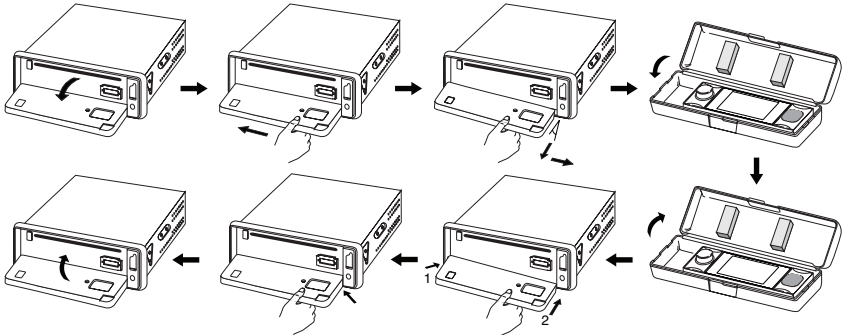

Notes:

- Do not press the front panel hard against the unit when attaching it. It can be easily attached by pressing it lightly against the unit.
- When you carry the front panel with you, put it in the supplied front panel case.
- Do not press hard or apply excessive pressure to the display window of the front panel when attaching it to the unit.

CLEANING THE CONNECTOR

The unit may not function properly if the connectors between the unit and the front panel are contaminated with dirt. In order to prevent this from happening, detach the front panel by pressing the button and clean the connectors from time to time.

Clean the connectors with a cotton swab and contact cleaner as illustrated. Clean each pin carefully and make sure not to damage the connecting points.

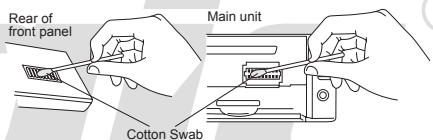

INSTALLATION & WIRING CONNECTION

TO SUPPORT THE UNIT

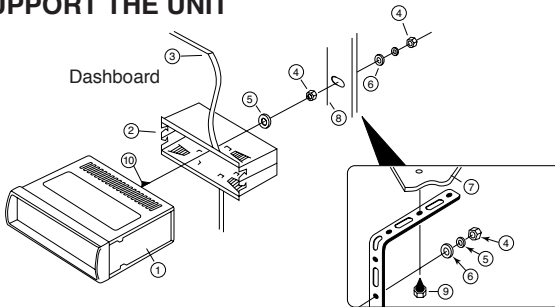

1. UNIT
2. RELEASE CASE
3. DASH BOARD
4. HEX NUT
5. LOCK WASHER
6. PLAIN WASHER
7. CAR BODY
8. REAR SUPPORT STRAP
9. TAPPING SCREW
10. M5 X 15 HEX BOLT

WIRING CONNECTION

IN / OUT CONNECTOR

DVD Audio Out: White (L) Red (R)

Connect this wire to rear seat A/V systems

Audio Out (Front): White (L) Red (R)

Audio Out (Rear): White (L) Red (R)

Subwoofer Output: Yellow

2 Video Out: Yellow

Connect to external video monitors

Video In: Yellow

Connect to external Video equipment

Rear camera In: Blue

Connect to rear camera output

CONTROL WIRE

Parking (Gray) : Connect this wire to the hand brake system

Tel mute (Black) :

This unit is equipped with a wire that will mute the audio output when a signal is received from a cellular phone equipped with a muting output. When a cellular call is received, a signal sent from the phone to the Tel Mute wire causes the unit to mute the audio output. When the call is over the audio level is automatically restored. To use this feature, you must have a cellular phone handsfree kit with a muting output that can be connected to the Tel Mute control wire.

- Please see the installation instructions for the cellular telephone to identify the correct connection for the TEL MUTE wire.

Rear camera (Red) : Connect to vehicle back-up light circuit

In order to activate REAR camera input, this wire should to be connected to high voltage (5V or 12V).

DRIVING WITHOUT VIDEO DISPLAY

For localities where video display is prohibited while the vehicle is in motion, follow the instructions below.

Caution: Always follow local laws regarding driving with video.

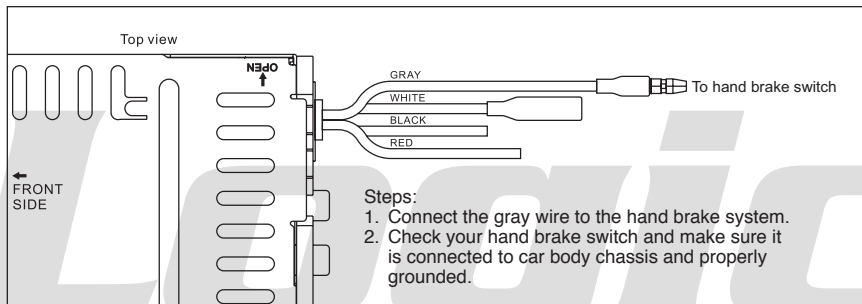

WIRING CONNECTION

DRIVING WITH VIDEO DISPLAY

Follow the instructions below so video will display even when the vehicle is in motion.

Caution: Always follow local laws regarding driving with video.

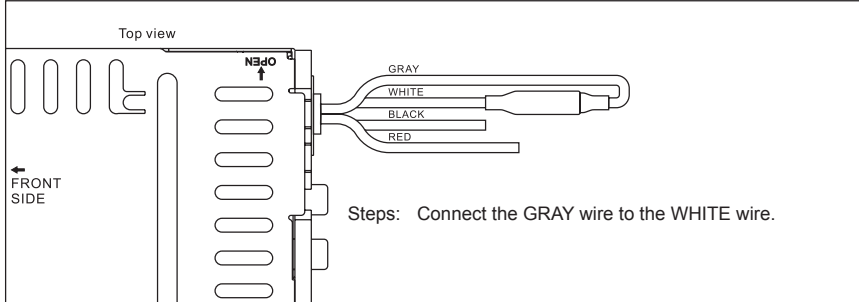

INSTALLING REAR CAMERA FOR REVERSE MOTION

Follow the instructions below to have the unit automatically switch to a rear camera (not included) to guide the driver when parking or moving in reverse.

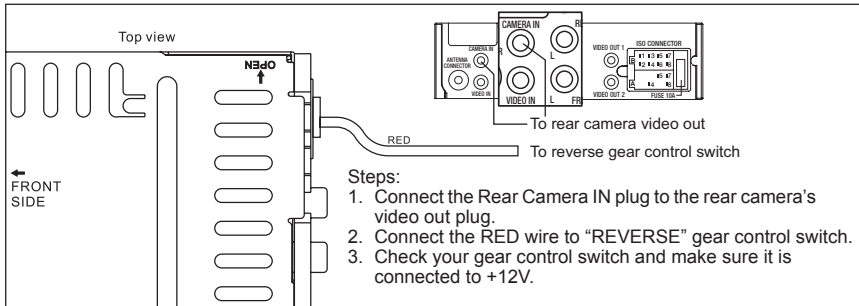

CONNECTOR A

4. MEMORY +12V
5. AUTO ANTENNA OUTPUT
7. +12V (TO IGNITION KEY)
8. GROUND

NOTE: (connector A no. 7) must be connected (ACC) in order to avoid weakening the car battery when the motor will not be running for long periods.

CONNECTOR B

1. REAR RIGHT SPEAKER (+)
2. REAR RIGHT SPEAKER (-)
3. FRONT RIGHT SPEAKER (+)
4. FRONT RIGHT SPEAKER (-)
5. FRONT LEFT SPEAKER (+)
6. FRONT LEFT SPEAKER (-)
7. REAR LEFT SPEAKER (+)
8. REAR LEFT SPEAKER (-)

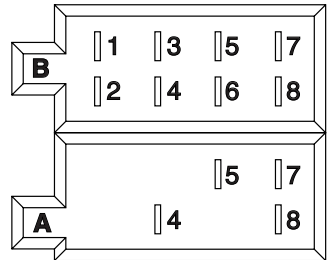

Maintenance

FUSE REPLACEMENT

If the fuse blows, check the power connection and replace the fuse. If the fuse blows again after the replacement, there may be an internal malfunction. In this case, consult your nearest repair center.

Warning

Use the specified amperage fuse for each lead. Use of a higher amperage fuse may cause serious damage.

OPERATION

LOCATIONS OF CONTROLS (MAIN UNIT)

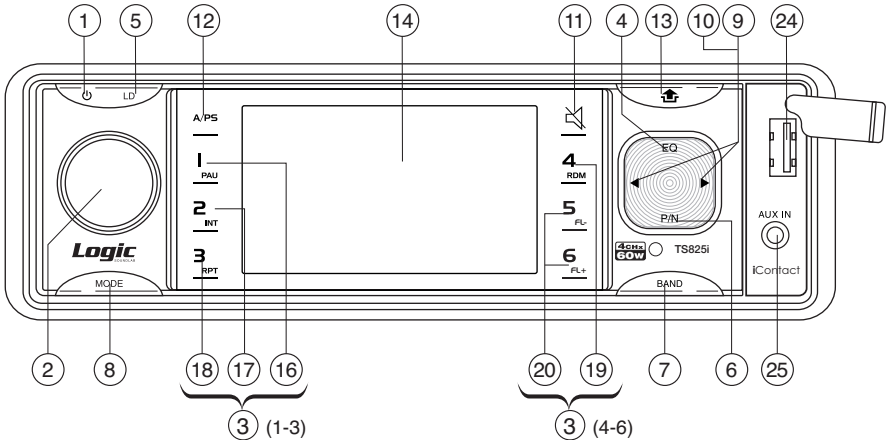

1. POWER ON/OFF ()
2. SELECT FUNCTION BUTTON
3. PRESET STATIONS (1,2,3,4,5,6)
4. EQUALIZER CONTROL (EQ)
5. LOUDNESS BUTTON (LD)
6. PAL / NTSC SYSTEM (P/N)
7. BAND BUTTON (BAND)
8. MODE BUTTON (MODE)
9. CD TRACK / SEARCH BUTTON
10. AUTO SEEK TUNING
11. MUTE BUTTON ()
12. AUTO SEEK SEARCH TUNING (A/PS)
13. PANEL RELEASE BUTTON ()
14. TFT-LCD DISPLAY
15. CD EJECT BUTTON ()
16. PLAY/PAUSE BUTTON
17. INTRO BUTTON
18. REPEAT BUTTON
19. RANDOM BUTTON
20. PREVIOUS / NEXT FOLDER
21. RESET BUTTON
22. CD SLOT
23. SD/MMC COMPATIBLE MEMORY CARD SLOT
24. USB COMPATIBLE PORT
25. FRONT AUX IN

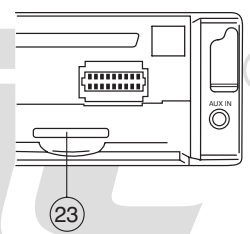
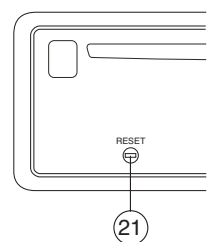
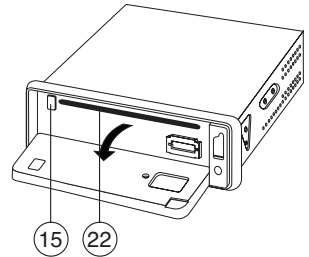

OPERATION

LOCATIONS OF CONTROLS (REMOTE CONTROL)

1. POWER ON/OFF
2. MODE
3. PLAY/PAUSE
4. TITLE / PLAYBACK CONTROL
5. SELECT
6. SEEK+/SEEK- / CD TRACK/SEARCH
7. VOL +/VOL-
8. GOTO
9. AUDIO
10. ENTER
11. NAVIGATION
12. AUTO SEEK / PRESET SCAN / REPEAT
13. RANDOM / BAND / LOUDNESS
14. DUAL
15. INTRO
16. SUBTITLE
17. SETUP
18. EQUALIZER / ANGLE
19. SLOW MOTION
20. ZOOM / A-B REPEAT
21. STOP
22. CLOCK / ON SCREEN DISPLAY
23. MUTE
24. MAIN MENU
25. STEP (FRAME BY FRAME PLAYBACK)
26. PAL / NTSC SYSTEM
27. PREVIOUS / NEXT FOLDER
28. TWO DIGIT TRACKS SEARCHS
29. KEYPAD

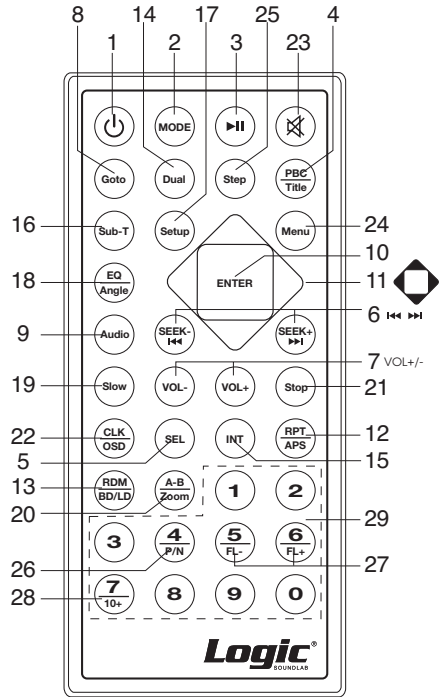

Use and care of the remote control

Installing the battery

Slide the tray out on the back of the remote control and insert the battery with the (+) and minus (-) poles pointing in the proper direction.

- On first use, pull out the film protruding from the tray.

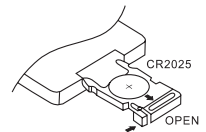

CAUTIONS

- Remove the battery if the remote control is not used for a month or longer.
- Do not recharge, disassemble, heat or dispose of the battery in fire.
- Do not store the battery with metallic materials.
- In the event of battery leakage, wipe the remote control completely clean and install a new battery.
- When disposing of used batteries, please comply with government regulations or environmental public institution's rule that apply in your local area.
- Always check carefully that you are loading the battery with plus (+) and minus (-) poles facing the proper directions.

Using the remote control

Point the remote control in the direction of the front panel to operate.

IMPORTANT

- Do not store the remote control in high temperatures or direct sunlight.
- Do not let the remote control fall onto the floor, where it may become jammed under the brake or accelerator pedal.

OPERATION

GENERAL OPERATIONS

Turning the unit ON/OFF (⏻)

Press “⏻” button to turn on unit. To turn off, press and hold the button again.

MAIN MENU

This is the icon menu and you can simply access all features by tapping on the touchscreen buttons.

Press **MODE** on the remote control to show the MAIN MENU.

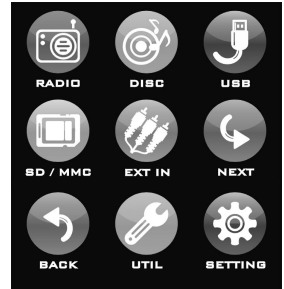

Selecting a source (MODE)

Press **MODE** repeatedly to switch between TUNER, CD/DVD, AUX IN, USB or SD/MMC mode.

Loading a Disc

1. Press to open the front panel
2. Insert a disc into the disc loading slot

Ejecting a Disc

Press button to eject disc

Adjusting Volume

- Head Unit: Rotate **VOL** knob right or left to increase or decrease volume.
- Remote Control: Press **VOL+** or **VOL-** to increase or decrease volume.

Mute Button

- Head Unit: Press button to mute the sound at once. Press again to return to previous volume level.
- Remote Control: Press button.

Loud Button (LD)

Press **LOUD** button to turn on/off LOUD feature.

Equalizer (EQ)

Remote: Press **EQ** button. Under *DSP-preset*, select the desired EQ by pressing (◀/▶).

Subwoofer

On Main menu, touch **SETTINGS** > EQ SETTINGS > Subwoof (ON/ OFF).

Remote: Press **EQ** button to EQ setting, select **SUBWOOFER** On/ Off by pressing (◀/▶).

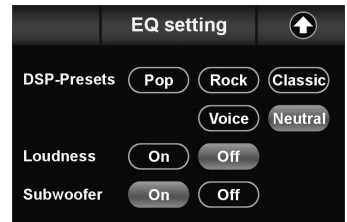

CLOCK

To show clock, switch to *RADIO* mode and press **CLK** on remote control.

How to Set Clock

1. Press and hold **MENU** on remote control.
2. Press **UTIL** function.
3. Press and hold **CLK** button. Hour start flashing.
4. Press (▲/▼) on remote to set the hour. When done, press **CLK** button again to set minutes.
5. Press (▲/▼) to set the minutes.
6. Press **X** to save and exit.

OPERATION

DUAL ZONE OPERATION

DUAL Operation is a feature that lets the front seat passengers listen to the radio while the rear seat passengers watch and listen to other programming. This unit supports connection of external AV devices such as video monitors with built-in speakers through the AUDIO and VIDEO outputs. Dual Operation is available when one or more of the multimedia functions are used: Disc, USB, or SD/MMC.

1. Connect the AUDIO OUT and VIDEO OUT RCA jacks on the back of head unit to the AV Inputs of an external AV device. The audio outputs are line level so an external amplifier or amplified speakers will be needed.
2. Press and hold **MODE**. Select memory card or USB source.
3. Press the **DUAL** button on the remote control to select the desired mode. On the left side of the display you will see one these letters: T = TUNER, C = CARD, U = USB, D = DISC. Continue pressing the DUAL button to cycle through the functions.
4. The normal tuner display has blue highlights. When in DUAL mode the display shows a different radio screen format. This indicates the unit is in DUAL Operation mode.

Note: *This Dual Operation feature works when you connect this unit to an external AV system installed in the vehicle. It is designed for systems set up to have a secondary AV system in the rear seat area.*

VIEWING PHOTOS

1. Insert disc, USB memory stick or SD/MMC card containing picture files.
2. Using remote (◀ / ▶), select PHOTO function and press **ENTER**.
3. Using remote (▲ / ▼), select a file to view and press **ENTER**.

Note:

Press **MENU** on remote control to exit photo playback.

Press **MENU** on remote control will also go back one level or return to previous menu.

RESET

The reset button is placed on the housing behind the faceplate. To reset, use a sharp pointed object. Press and hold the **RESET** button for 2 seconds.

The reset button is to be activated for the following reasons:

- Initial installation of the unit when all wiring is completed.
- None of the function buttons operate properly.
- Error symbol appears on the display.

LISTENING TO RADIO

Band (BD)

Pressing this key repeatedly will cycle between each band as follows: FM1---FM2---FM3---AM1---AM2.

Automatic or Manual tuning (SEEK + / SEEK -)

When pressed quickly, these keys operate as MANUAL tuning mode.

When pressed longer than 1 second, these keys operate as AUTOMATIC tuning mode.

Auto Seek/Preset scan (A/PS)

Preset Scan (PS) - By pressing quickly, the radio plays each preset station for 5 seconds.

Auto Seek (AS) - By pressing longer than 1 sec, auto seek is activated. The 6 strongest stations are preset and stored in the corresponding preset number. When Auto Seek operation is finished, the radio executes the preset scan.

Storing and Recalling Frequencies

If you press any of the NUMBER (1-6) you can easily store up to six broadcast frequencies for later recall with the touch of a button.

1. Choose a desired BAND.
2. When you find a frequency that you want to store in memory, press a NUMBER (1-6) and hold until the preset number shows and lit in the display.
3. The selected radio station frequency has been stored in memory. The next time you press the same NUMBER (1-6) the radio station frequency is recalled from memory.

Note: *Up to 18 FM / 12 AM stations can be stored in the memory.*

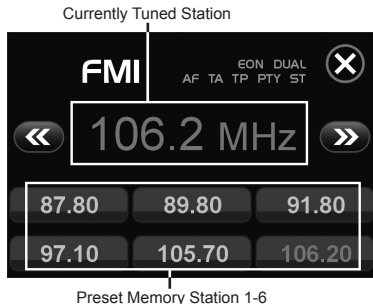

OPERATION

OPERATIONS COMMON FOR CD/MP3/WMA/VCD/DVD/MP4

Search Previous / Next Folder

During MP3 playback, press and hold **FL-/FL+** button to go to previous /next folder.

Note: *Disc / media sources must contain folder name for this function to work.*

Specifying particular track

During playback, all track file names under a folder will be displayed on the screen with their corresponding track number. You can use the navigation keypad on the remote control to access each file.

Tips:

To select track 3, press 3.

To select 13, press and hold 10+ follow by 3.

To select 23, press and hold 10+ (2 times) follow by 3.

Random Playback

Press **RDM** during playback to play the tracks in random/shuffle order. Press it again to cancel.

Stopping Playback

1. Press **Stop** on remote control during playback to stop playback. That position is stored in memory.

2. Press **▶II** to continue. Playback starts from the position at which it was stopped.

Note: *There is no STOP function in audio playback. Audio playback uses ▶II function.*

Fast Forward / Fast Reverse

Note: **⏮** or **⏭** on remote control is the same function as **▼** or **▲** on head unit.

1. During playback, press and hold **▼** or **▲** unit scans at the speed of x2 - x4 - x8 - x20

2. To resume normal playback at a desired point, press **▶II**.

Note: *No sound is played during fast forward / fast reverse.*

Finding the Beginning of Tracks

During playback, press **▼** or **▲**.

▼ : Press to start playback from the beginning of the previous chapter or track.

▲ : Press to start playback from the beginning of the following chapter or track.

Pause Playback

During playback, press **▶II**. Press again to resume playback.

A-B Repeat Playback

This feature allows you to loop playback a section of the movie starting from Point A to Point B.

1. Press the **▶II** button to play the movie.

2. Once you have located the section you wish to playback on loop repeat, press and hold **A-B** button. You will see "Rep-A" on the screen.

3. Let the movie play on until you have reached the end of the section you wish to watch on continuous loop. Once you have reached this point, press and hold **A-B** button again. "Rep-A-B" will appear on your screen. Playback will now start from Point A -B.

4. To stop A-B repeat playback, press and hold **A-B** button once more until "A-B CANCEL" disappears and normal playback resumes.

Displaying information (OSD)

During playback, you can see all DVD disc information and current play settings. Display will show related playback time, elapse time, title number, chapter number and other information.

1. Press **OSD** on the remote control once. Unit will display the play time and the disc elapse time.

2. Press it once more and all other settings information will be displayed.

OPERATION

LISTENING TO CD/MP3/WMA

Folder Name

Track file names

Player Info

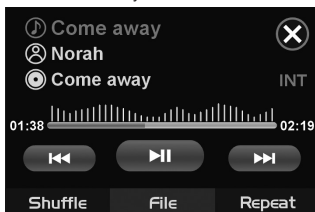
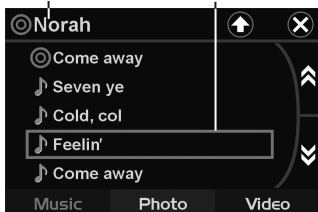

Tips: When folder menu is activated, pressing ◀/▶ button on front panel will toggle between MUSIC / PHOTO / VIDEO options while pressing SEEK-/SEEK+ on remote will display the files found on next page.

Intro Playback (Audio CD only)

Press INT during playback to play the first 10 seconds of each track.

Repeat tracks

You can choose between repeat playback of a single track or all tracks.

1. Press RPT on the remote control during playback.
2. Every time you press this button, the unit switches to the following settings:

Repeat 1 - Repeat the current playback track.

Repeat Folder - Repeat the currently played folder.

Repeat All - Repeat all folders and tracks.

Return / Go Back

Press TITLE on remote control to go back one level or return to previous menu.

Title

During music playback, press TITLE on remote to return to audio file lists.

SD/MMC compatible card input

Support MP3/WMA ID3 format music only.

1. Press button and the the front panel will open.
2. Detach the panel by pulling it towards you.
3. Carefully insert the SD/MMC card into the disc slot, attach back the panel. Unit starts playback automatically.

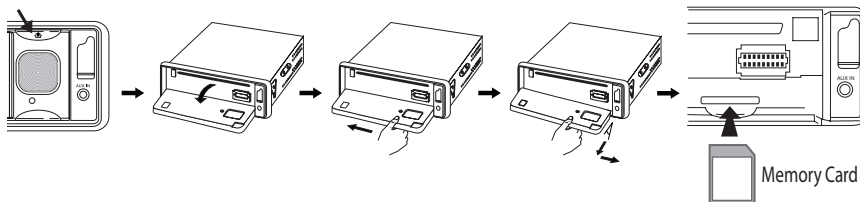

New Generation iContact Smart USB Port:

Enhanced control of connected Portable Media Such as Flash Drives and digital MP3 players by using function keys on the TS825i or the remote control unit.

TS825i features the latest ID3 Tag support, which allows you to see the song's name and which folder it's located in, on the black matrix display.

Front input iContact AUX IN at your fingertips:

Convenient easy to use front "AUX IN" input jack allows easy connection of Portable media such as iPod and other digital MP3 Players using the iContact cables included.

USB compatible port

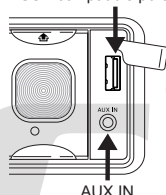

* IMPORTANT INFORMATION:

Because of the great variety of products with USB, SD and MMC card ports, and their manufacturer specific functions, we can neither guarantee that all devices will be recognized nor that all operating functions will work properly.

OPERATION

PLAYING DVD/VIDEO CD/MP4

Playback

1. Insert a disc. When the disc includes a menu, the menu is displayed. When a disc is already inserted, press **MODE** to switch to disc mode.
2. On DVDs and video CDs with playback control (PBC), menu screens may appear automatically. If this happens, perform the operation described below to start playback.

CAUTION: Make sure that the Video TV system settings are set correctly according to the disc you are playing. If you are not sure, leave it set to “**Auto**”. Improper setup of TV system might cause the video to stop/skip/pause playing although audio might continue to play. You can setup video TV settings using the **SETUP** feature of the remote control. Refer to “**SETTING UP THE DVD PLAYER**” section.

DVD menu

Press **▲**, **▼**, **◀**, **▶** to select the desired item, then press **Enter**.

Video CD menu

Use the number keys (“0” to “9”) to select the desired number, then press **Enter**. The menu screen does not appear when the PBC function is turned off. In this case, press and hold button to turn on PBC feature.

Turning PBC ON/OFF (VCD only)

PBC (Playback Control) is a feature found on VCD 2.0 and SVCD 1.0. PBC allows playback control and user interaction through the remote control or other input device. If PBC is on, the player won't auto start after inserting the disc because it will take time to select a program on disc. If PBC is off, the player will auto playback the program on the disc one by one.

1. To turn ON PBC function, press **PBC** on the remote control. To turn OFF, press the button again.

Note: Not all VCD/SVCD discs have PBC functions.

Repeat Playback

FOR VCD

1. Press **RPT** on the remote control during playback.
2. Every time you press this button, the unit switches to the following settings:

Repeat 1 – Repeat the current playback track.

Repeat All – Repeat all folders and tracks.

Repeat Off – Turn OFF repeat function.

Note: PBC feature in VCD disc needs to be stopped in order to use Repeat playback.

FOR DVD

You can choose between repeat playback of a title or chapter.

1. Press **RPT** on the remote control during playback.
2. Every time you press this button, the unit switches to the following settings:

Repeat Title – Repeat the current playback title.

Repeat Chapter – Repeat the current playback chapter.

Repeat Off – Turn OFF repeat function.

Searching for particular track using GOTO

You can use the GOTO function to search for a desired track number or particular point of a track to play.

1. Press **GOTO** on the remote control during playback. Time and track number search appears.
2. Enter the minutes and seconds for the currently played track if you want to search by time. Press **Enter**.
3. Enter track number if you want to search by tracks. Press **Enter**.

Changing audio language during playback (Multi-audio)

DVDs can provide audio playback with different languages and different systems (Dolby Digital, DTS etc.). With DVDs featuring multi-audio recordings, you can switch between languages/audio systems during playback.

VCD can provide different audio languages usually divided into left and right channels.

1. To choose different audio, simply press **Audio** on the remote control repeatedly during playback.

Note:

- With some DVDs, switching between languages/audio systems may only be possible using a menu display.
- You can also switch between languages/audio systems using **SET-UP MENU**.

Changing the subtitle language during playback (Multi-subtitle) – (DVD only)

With DVDs featuring multi-subtitle recordings, you can switch between subtitle languages during playback.

1. Press **Sub-T** on the remote control during playback. Press repeatedly until the supported desired subtitle appears.

Note:

- With some DVDs, switching between subtitles may only be possible using a menu display.
- You can also switch between subtitles using **SET-UP MENU**.

Changing the viewing angle during playback (Multi-angle) – (DVD only)

With DVDs featuring multi-angle (scenes shot from multiple angles) recordings, you can switch among viewing angles during play-back.

1. Press and hold **Angle** on the remote control during playback of a scene.

Title (DVD only)

During DVD playback, press **Title** on remote control to return to FIRST title.

Return to Root Menu (DVD only)

During DVD playback, press and hold **MENU** on head unit or remote control to return to root menu.

Note: Some DVDs may not contain a root menu.

Slow motion playback

This feature lets you slow down playback.

1. Press **Slow** on the remote control during playback.
2. Pressing it repeatedly will switch playback to the following steps: 1/2 - 1/3 - 1/4 - 1/5 - 1/6 - 1/7.

Note:

- To resume normal playback, press **PLAY/PAUSE** (▶|).
- There is no sound during slow motion playback.
- With some discs, the image may be unclear during slow motion playback.

Zooming in During Playback

You can zoom into the picture during playback.

1. Press **ZOOM** on the remote control during playback.
2. Every time you press this button, the unit will zoom 2 - 3 - 4 - 1/2 - 1/3 - 1/4 times and OFF.

Frame-by-frame playback

This lets you move ahead one frame at a time during playback.

1. Each time you press **Step** button on remote control, you move ahead one frame. To return to normal playback, press **▶|**.

PAL / NTSC (P/N)

Press and hold **P/N** button to switch between PAL, NTSC system.

Return / Go Back

Press **MENU** on remote control to go back one level or return to previous menu.

CUSTOMIZING AUDIO / VIDEO SETTINGS

AUDIO SETUP

1. Press **VOL** knob to enter AUDIO setup. Selected item will be highlighted. You can set BASS, TREBLE, BALANCE, FADER.
2. Press **▼** or **▲** button to select item. Rotate **VOL** knob to make adjustments.
3. Press **VOL** knob to exit settings.

VIDEO SETUP

1. Press and hold **VOL** knob to enter VIDEO setup. Selected item will be highlighted. You can set BRIGHTNESS, CONTRAST, SATURATION, HUE, SHARPNESS.
2. Press **▼** or **▲** button to select item. Rotate **VOL** knob to make adjustments.
3. Press and hold **VOL** knob to exit settings.

Note: Depending on model's features, some items may not show on screen.

OPERATION

SETTING UP THE DVD PLAYER

You can customize the unit to suit your preference. You can set the language and other video and audio settings so when playback starts it will always use your preferred settings.

Important:

1. Load any disc into the unit before you can access the setup.
2. Press **SETUP** on the remote control.
3. Use (◀/▶) to return / enter category.

Settings	Category	Options
System Setup	TV System	NTSC, PAL, AUTO
	Auto Play	ON, OFF
	TV Type	4:3PS, 4:3LB, 16:9
	Password	Setup password
	Rating	Setup rating level
	Default	Restore to factory settings
Language Setup	OSD Language	Select preferred options appear on screen
	Audio Language	
	Subtitle Language	
	Menu Language	
	MPEG4 Language	
Video Setup	Brightness	Use navigation keys on remote control to setup desired level.
	Contrast	
	Hue	
	Saturation	
	Sharpness	

Setting Rating Password

- 1 Press **Setup** on the remote control.
- 2 Using Navigation keys select *System Setup* > *Password* and press **Enter**.
- 3 Enter new 4 digit password and press **Enter**. The unlock logo will switch to lock indicating a password has been set.

Note:

- The default password is '0000'.
- In case you forgot your password, you can use the master password '0000' to unlock and reset the password.
- Master password will only work while **SETUP** button is pressed during playback.

TROUBLESHOOTING

Check all wiring connections before referring to the list below. If problems persist after consulting the list, contact your nearest service dealer.

SYMPTOM	CAUSE	SOLUTION
No power.	The car ignition switch is not on.	If the power supply is properly connected to the car accessory circuits, but the engine is not running switch the ignition key to "ACC".
	The fuse is blown.	Replace with a new fuse of equal rating.
Disc cannot be loaded or ejected.	A CD is in the player	Remove the disc in the player, then insert a new one.
	Disc is inserted upside down	Insert the CD with the label facing up.
	CD is very dirty or defective.	Clean the disc or try to play a new one.
	Temperature inside the car is too high.	Allow the ambient temperature to cool to normal level.
	Condensation is present in the CD player.	Leave the player off for an hour or so, then try again.
No sound.	Volume control is set to the minimum level.	Adjust volume to a desired level.
	Wiring is not properly connected.	Check wiring connection.
Sound skips.	The installation angle is more than 30 degrees.	Make sure the head unit is installed at an angle of less than 30 degrees from horizontal.
	The disc is extremely dirty or defective disc.	Clean the CD, then try to play a new one.
The operation keys do not work.	The built-in microcomputer is not operating properly.	Press the RESET button and try again.
	Front panel is not attached or seated properly.	Remove and reinsert the front panel according to the instructions in this manual and try again.
The radio does not work. The radio station automatic selection does not work.	The antenna cable is not connected.	Insert the antenna cable firmly.
	The signals are too weak.	Select a station manually.

TROUBLESHOOTING

PROBLEMS DURING DVD PLAYBACK

SYMPTOM	CAUSE	SOLUTION
Playback is not possible.	The loaded disc has a different region number from this unit.	Replace the disc with one featuring the same region number as this unit.
A parental lock message is displayed and playback is not possible.	Parental lock is on.	Turn parental lock off or change the level.
Dialog language (and subtitle language) cannot be switched.	The DVD playing does not feature multiple language recordings.	You cannot switch among multiple languages if they aren't recorded on the disc.
	You can only switch between items indicated in the disc menu.	Switch using the system settings.
No subtitles are displayed.	The DVD playing does not feature subtitles.	Subtitles are not displayed if they are not recorded on the disc.
	You can only switch between items indicated in the disc menu.	Switch using the system settings.
Switching the viewing angle is not possible.	The DVD playing does not feature scenes shot from multiple angles.	You cannot switch between multiple angles if the DVD dose not feature scenes recorded from multiple angles.
	You are trying to switch to multiple angles viewing of a scene that is not recorded from multiple angles.	Switch between multiple angles when watching scenes recorded from multiple angles.

PROBLEMS DURING VIDEO CD PLAYBACK

SYMPTOM	CAUSE	SOLUTION
The PBC (playback control) menu display cannot be called up.	The Video CD playing does not feature PBC.	This operation is not possible with Video CDs not featuring PBC.
	PBC is turned off.	Turn PBC on.
Repeat play and track/time search are not possible.	PBC is turned on.	Turn PBC off.

SPECIFICATIONS

TS825i

MP3-Compatible AM/FM DVD Receiver

CD/MP3/WMA PLAYER SECTION

Signal to Noise Ratio	> 60 dB
Channel Separation	> 50 dB (1kHz)
Frequency Response	20Hz - 20 kHz

TUNER (FM)

Frequency Range	87.5-107.9 MHz
Sensitivity	2.8 μ V
Stereo Separation	30 dB
Signal to Noise Ratio	50 dB
Channel Step	200 kHz

TUNER (AM)

Frequency Range	530-1710 KHz
Usable Sensitivity	32 dB μ V

LINE-OUT

Output	5 V (max.)
Impedance	10k Ohm

GENERAL

Power Supply	12V DC (10.8-15.6V allowable)
Speaker Impedance	4 or 8 Ohm
Output Power	60 Watts x 4 Channels